

Salient associates

1. We are a full-service architectural firm with extensive experience and particular expertise in facility planning for colleges and universities.

2. No project is too big or too small. Our projects include complete floors of faculty and administration offices, classrooms, student and faculty lounges, meeting rooms, and reception rooms equipped with kitchens and sophisticated audio/visual systems.

3. We specialize in wireless communications technologies including provider-neutral, in-building support for cell phones and LAN terminals.

4. We produce detailed, very meticulous drawings! We take great pains in making our plans thorough, super-informative and appropriate to the project.

CONTACT US:

Call or write us at our office address, or you can email one of our principals directly:

Richard Bonanomi: rb@salientassociates.com

Mark Gatani: mg@salientassociates.com

Charles Whelan: cw@salientassociates.com

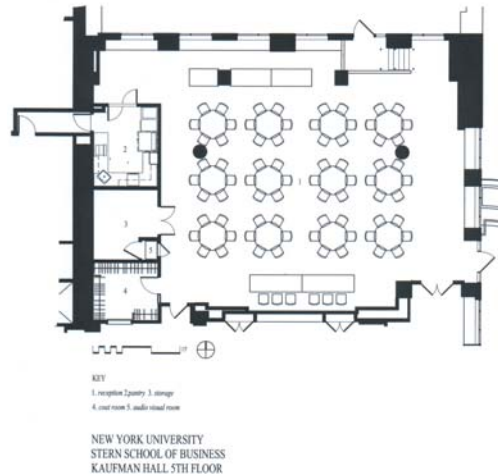

45 North Dean Street
Englewood, NJ 07631

Tel: 201-567-0032

Fax: 201-567-9556

314 East Woodland Avenue
Brielle, NJ 08730



WHAT WE STRIVE FOR

ART – understated and elegant design. We provide tasteful pizzazz and that special detail to make your building “stand out”. In addition we incorporate contextual elements from the surrounding community to make it “fit in”.

QUALITY – solid, no-nonsense construction that goes beyond industry standards. We are very interested in energy-efficient assemblies and environment-friendly products. Natural materials such as stone, brick and wood are our preferred materials.

SERVICE – thoroughness, timeliness and attention to your needs. We are keenly aware that budget and schedule are very important to you, and that the architectural strategy impacts the budget and schedule more than anything! We will keep your concerns in mind as we develop your design. And we will keep you extremely informed of what we are doing.

OUR RESOURCES:

- Principals Mark Gatanis, Richard Bonanomi and Charles Whelan have more than 70 years of architectural experience combined.
- Our staff of ten provides depth and flexibility.
- We use the latest computer technology to produce and deliver your drawings.



NYU STERN SCHOOL

Salient Partner, Richard Bonanomi, was the principal design architect and leader of the design team when the NYU Graduate School of Business built its new, 11-story home on the Washington Square campus. Because the NYU facilities team values his skill, his dedication, and his level of service, Richard has been invited to return, time and time again, to work on a wide variety of renovation projects.

SOME RECENT PROJECTS:

NYU Kaufman Management Center Tenth Floor: Complete gut of approximately 20,000 square feet and rebuild as offices for administration and faculty in three phases.

NYU Kaufman Management Center Fifth Floor: Complete gut of 4,000 square feet and rebuild as high profile, presentation and reception room.

NYU Tisch Hall Second Floor: Complete gut and rebuild as specialized classrooms and student meeting rooms

NYU Kaufman Management Center Fourth Floor South: Conversion of two classrooms to a graduate student lounge.

NYU Tisch Hall Concourse Level: Conversion of flat-floor classrooms to 70 person tiered classrooms with digitized projector and teacher’s console. This project also involved a computer lab.

NYU Tisch Hall Concourse Level: New passageway between buildings with renovation of large computer lab and offices.

NYU Kaufman Management Center Fourth Floor North: Conversion of student classrooms to high-profile executive programs classroom with rear projection.